

## Palmers Green Safer Neighbourhood Team News

Burglary is lower than December. Please make sure you are double locking your UPVC doors with a key as this could have prevented one burglary. Also please set your alarm if you have one. If you haven't used it for a while a service might be in order or an update to a monitored system if you don't already have one.

Be aware there was a distraction burglary on our neighbouring ward, Southgate Green on Limes Avenue. Two males posing to be from the water board gained entry to a property. Both males were white, aged 18-20 years. One with a bald head and 5'8". The other with ginger hair and a beard. Both were wearing black jackets.

Motor vehicle crime decreased in January. The catalytic converter thieves have made a reappearance again. The car mostly targeted is the Toyota Auris. You can have a lock fitted to the catalytic converter and have it marked. Check with your car's manufacturer for the best lock to protect it.

Please be aware when in the bank. A victim withdrew £700 which was placed in a white envelope and then in his coat pocket. When boarding the bus there was a hold up and a crowd of people surrounded him. When he got home he discovered the envelope with the money inside has gone. Please don't withdraw large amounts of cash unless you

have to. Use bank transfers if possible or set up direct debits or standing orders.

Please also be aware that the scam calls from a male saying he's a police officer and you are helping with a bank investigation into fake money or your cards have been found on a suspect in police custody is still making the rounds. A recent victim had nearly a £1000 taken from two accounts after handing over their cards to what they thought was helping a legitimate investigation.



A number of residents and businesses have contacted us about beggars on Green Lanes. We have issued a Community Protection Notice (CPN) to one near Sainsburys Local at the beginning of February after he broke the warning CPN he received halfway through January. We will be going through the same warning process then full CPN if they persist with the new faces that have appeared over the last few weeks. They will also be offered referrals to services and Streetlink if they are homeless.

Welcome to the latest **Palmers Green Ward Safer Neighbourhoods Newsletter**. This edition covers the **crime figures on Palmers Green Ward for January 2020**.

## Crimes Recorded this month

There were 102 recorded crimes on the Ward during this period.

### Burglary

There was 1 attempted residential burglary, 8 residential burglaries, 1 garage burglary and 1 distraction burglary this month.

#### **HAZELWOOD HOUSE, NEW RIVER**

**CRESCENT**, on 1<sup>st</sup> January between 8.20 and 8.30pm. The victim opened the door to a male who said he had just seen someone trying to get in her rear door. He asked to be let in to help her check the rear door for damage and didn't move from the hallway.

A possible second person has come in while she was distracted and taken jewellery from her bedroom and money from her living room when she went to check the bedroom.

**LODGE DRIVE**, between 1pm and 1.30pm, 2<sup>nd</sup> January. Porch door lock was slipped as it was not double locked. Pane of glass in the front door was then smashed and Yale lock opened. Suspects searched the house and found the owner's wife in the bedroom and told her, her husband let them in to see to a leak before leaving.

**MUNSTER GARDENS**, on 9<sup>th</sup> January at 6.48pm. Neighbours heard noises and saw lights on in the house which is currently unoccupied and four males then jumped back over the side gate and made off in a car. Rear patio door has been smashed to gain entry. Bedrooms searched.

**PALMERSTON CRESCENT**, between 3pm and 10.22pm on 11<sup>th</sup> January. Rear door window has been smashed. Untidy search of all rooms.

**GREEN LANES**, between 11am, 11<sup>th</sup> January and 1.20am, 12<sup>th</sup> January. Rear door forced open.

**PALMERSTON CRESCENT**, between 12pm and 6pm, 11<sup>th</sup> January. Garden door opened possibly with keys taken from next door flat which was also burgled. Jewellery and electronic equipment taken.

**THE FAIRWAY**, between 1.30pm and 2pm, 17<sup>th</sup> January. Suspects have jumped over

the side gate then forced it open. They have tried to force the side doors and failed before trying the rear patio doors then smashing the window. Bedrooms searched and jewellery and paperwork taken.

#### **Garages, MINTERN CLOSE, HEDGE LANE,**

between 8am, 18<sup>th</sup> January and 8am, 21<sup>st</sup> January. Unknown person has gained entry to a garage and taken power tools.

**NORTH CIRCULAR ROAD**, between 9pm and 9.05pm, 24<sup>th</sup> January. Suspect attempted to force open the front door making noise which disturbed the resident and the suspect made off when he saw him.

**FIRS LANE**, between 8.30pm, 24<sup>th</sup> January and 12.20am, 25<sup>th</sup> January. UPVC front door has been forced open. House untidily searched. Unknown if anything was taken.

**BLACKSMITHS COURT, GREEN LANES**, between 5pm, 24<sup>th</sup> January and 5pm, 26<sup>th</sup> January. Motorbike has been taken from a gated underground car park.

## LIFT - LOCK – REMOVE

**Please remember to double lock your front doors whether you have a UPVC door or have a Yale and mortice. If you also have a UPVC porch door then double lock that too. If you have the security installed, then please use it.**

**Please also consider the use of timer switches to light your houses up after dark if you are not yet home.**

[We still offer all residents the opportunity of having a crime prevention survey carried out on their home. Simply contact us via the details on this newsletter to arrange an appointment](#)

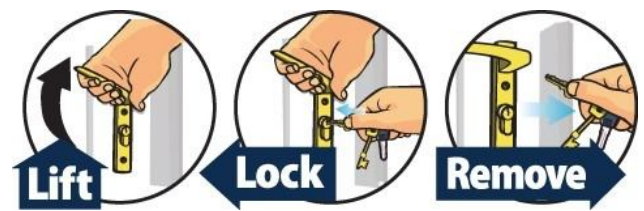

**PLEASE TAKE NOTE OF THE INSTRUCTIONS FOR DOUBLE LOCKING A UPVC (THREE OR FIVE POINT LOCKING SYSTEM) DOOR.**

If a UPVC door is not locked with a key the door handle goes down when tried and is left very weakly secure with a very small piece of triangular metal going into the frame. This point

on the doorframe near the lock is where the suspects target with their screwdrivers or crowbars and can pop your door open sometimes with very little effort.

## Motor Vehicle Crime

There were 15 thefts from motor vehicles and 6 thefts of motor vehicles reported in January.

**BIRCH AVENUE**, 1201am, 3<sup>rd</sup> January. N reg Hyundai. Car taken from location.

**BARROW CLOSE**, between 11am and 11.40am, 7<sup>th</sup> January. Y reg Toyota Yaris car taken from location.

**HEDGE LANE**, between 1209am, 4<sup>th</sup> January and 12.01am, 6<sup>th</sup> January. 54 Renault Clio car taken from location.

**ECCLESBOURNE GARDENS**, between 1201am, 26<sup>th</sup> December and 11.59pm, 1<sup>st</sup> January.

Number plates taken from vehicle.

**LIGHTCLIFFE ROAD**, between 12pm and 1pm, 7<sup>th</sup> January. Catalytic converter taken from a Honda Jazz.

**SHAPLAND WAY**, between 9.30am and 4pm, 7<sup>th</sup> January. Catalytic converter taken from a Toyota Auris.

**OAKTHORPE ROAD**, between 9.15am and 2pm, 11<sup>th</sup> January. Catalytic converter taken from a Lexus.

**HAZELWOOD LANE**, between 7pm, 12<sup>th</sup> January and 7.15am, 13<sup>th</sup> January. Catalytic converter taken from a Toyota Auris.

**NORTH CIRCULAR ROAD**, between 4pm, 13<sup>th</sup> January and 8.59am, 14<sup>th</sup> January. Front and rear number plates taken from a car.

**HAZELWOOD LANE**, between 10pm, 14<sup>th</sup> January and 8.30am, 15<sup>th</sup> January. Mercedes has been taken off the driveway without keys.

**NEW RIVER CRESCENT**, between 5-5.05am, 14<sup>th</sup> January. Catalytic converter taken from a Toyota Auris.

**KENMARE GARDENS**, between 6pm, 18<sup>th</sup> January and 12pm, 19<sup>th</sup> January. Catalytic converter taken from Toyota Auris.

**Morrisons Car Park, ALDERMANS HILL**, between 1230pm and 1pm, 20<sup>th</sup> January. Catalytic converter taken from a Honda Jazz.

**FIRS LANE**, between 6.15pm, 22<sup>nd</sup> January and 6.15pm, 23<sup>rd</sup> January. Catalytic converter taken from a Toyota Auris.

**CONNAUGHT GARDENS**, between 7pm, 22<sup>nd</sup> January and 11am, 23<sup>rd</sup> January. Catalytic converter taken from a Honda Jazz.

**ASH GROVE**, 2am, 24<sup>th</sup> January. Van's side door locks drilled out and tools taken.

**ENSIGN DRIVE**, between 11pm, 22<sup>nd</sup> January and 12pm, 23<sup>rd</sup> January. Catalytic converter taken from a Toyota Prius.

**FARNDALE AVENUE**, 3.35am, 27<sup>th</sup> January. Ford Transit van's side door has had holes cut in it near the locks to gain access and steal tools from a tool safe.

**THE LARCHES**, between 7.30am and 9.15pm, 27<sup>th</sup> January. Front number plate has been taken from a car.

**HEDGE LANE**, between 10am, 6<sup>th</sup> January and 7pm, 12<sup>th</sup> January. A Vauxhall Zafira was left parked opposite the last house on New River Crescent after it broke down. On returning the victim found it gone.

**ASH GROVE**, between 8pm, 28<sup>th</sup> January and 8.30am, 29<sup>th</sup> January. Catalytic converter taken from a Honda Jazz.

## Robbery

There 1 robbery and 1 attempted robbery reported in January.

**ECCLESBOURNE GARDENS**, 2.58pm, 4<sup>th</sup> January. The victim was approached from behind and the male suspect grabbed her handbag and tried to pull it away while the victim held on. She then let go and the male ran off towards Green Lanes.

In the Underpass, **GREAT CAMBRIDGE ROUNDABOUT**, 8.30am, 23<sup>rd</sup> January. The victim was walking through the underpass when approached by the suspect who asked him if he wanted to be shanked and to show him his phone, oyster and his address. Other people approached and the suspect left.



## “Cuppa with a Copper....”

**Come and say Hello, for help and advice on local issues**



### Up coming events

Our next contact points will be on:

**Saturday 22<sup>nd</sup> February**, 9am-10am, Parkrun contact point, Grovelands Park N21

**Sunday 1<sup>st</sup> March**, 3pm-4pm, contact point, Morrisons Café, Aldermans Hill N13

**Thursday 5<sup>th</sup> March**, 6pm-7pm, contact point, Costa, Green Lanes N13

**Wednesday 11<sup>th</sup> March**, 11am-12pm, contact point, Kiva, Green Lanes N13

**Tuesday 17<sup>th</sup> March**, 2pm-3pm, contact point, Chi Chi's, Green Lanes N13

**Monday 23<sup>rd</sup> March**, 6pm-7pm, contact point, Costa, Green Lanes N13

Please come along and have a chat about crime or any other issues concerning policing in Palmers Green.

### Team Members

Based at Southgate Police Station your Dedicated Ward Officers (DWOs) on Palmers Green ward are:

PS Matt Bloomfield

PC Jon Howarth

PC Usman Siddiq

PCSO Jennifer Arkwright

We can be contacted via the telephone on:

**0208 721 2835** (please leave a message if no answer – name, number, address)

Or via email:

[Palmersgreen.snt@met.police.uk](mailto:Palmersgreen.snt@met.police.uk)

### Useful Contacts

#### 24/7 Police Station

- Edmonton Police station  
462 Fore Street, Edmonton N9 0PW

#### Contact Point

**Wednesday 6pm - 7pm and Saturday 2pm - 3pm**

- Dugdale Centre  
39 London Rd, Enfield, EN2 6DS

**999 – URGENT attendance required – Response time of under 15mins.**

**101 - Police required but not as an emergency Response and also to report crime**

**0208 721 2835 – Palmers Green Ward - residents, wishing to contact their Local Policing Team for advice/arrange a visit/on going neighbourhood problems, etc. Slow time or appointment driven police attendance or communication required. Please do not use this number to report crime as this phone is not answered 24/7**

**You can now report crime online at [www.met.police.uk](http://www.met.police.uk) by clicking the Report button.**

**Don't forget to follow us on Twitter for crime prevention advice, local events and meetings.**

@MPSEnfield and Palmers Green Twitter  
@MPSPalmersGreen

Twitter is not staffed 24/7

We are also now on [www.nextdoor.co.uk](http://www.nextdoor.co.uk)  
under Enfield Police

Do not report crime on Enfield Twitter  
accounts. Report via @MettCC

In emergencies always call 999.

If anyone would like a crime prevention survey please contact us via 0208 721 2835 or if  
you have access to a computer email us at [palmersgreen.snt@met.police.uk](mailto:palmersgreen.snt@met.police.uk)

Palmers Green page can be found on the Metropolitan Police website by visiting  
[www.met.police.uk](http://www.met.police.uk) scrolling down the page and typing Palmers Green in the find your area  
box.



Many people we visit are asking for ID when we visit them. However, would you know what  
a real Met Police warrant card looks like?

The one BELOW is the real one. Check for the hologram on the warrant card, and the  
signature of the Commissioner NOT the holder.

