

Palmers Green Safer Neighbourhood Team News

We welcome Sergeant Kathryn Pinkerton to the team this month after a little gap since Sergeant Jon Howarth moved on to some of our other wards. Sergeant Pinkerton joins us from neighbourhood policing in Edmonton.

Thankfully burglary has gone back down during April. The majority were attempts.

After a few warmer days this week we are sure there will now be a few windows open in your properties. Please remember to shut and lock them before you leave your property unattended. An open or unlocked door or window is an easy access point.

How safe is your flat? Click for some advice on how to make it safer.

<https://www.met.police.uk/cp/crime-prevention/protect-home-crime/how-safe-is-your-flat/>

Theft from motor vehicles is still low around the ward at the moment but let's try and keep it that way. How often do you check your car is locked before you walk away? Keyless cars make this hard but if you have a car which requires you to press the fob do you pull the door handle to check it's locked before you walk away?

The most popular items to take from your vehicle are usually loose change and sun glasses but recently we've seen a number of bags of items to be returned being left in vehicle and taken. So try not to leave anything

in your car which you wouldn't miss just in case they find an open door. There was one arrest this month on Dorchester Avenue thanks to eagle eyed residents.

The catalytic converter thieves appear to be visiting the area again at the moment. If you have an older model BMW or Mercedes these have recently been targeted and also a few that haven't already had theirs taken from older model Honda Jazz and Toyota Prius. It may be wise to have a cage fitted around the catalytic converter and or a tilt alarm. Speak to your car's manufacturer for advice.
<https://www.met.police.uk/cp/crime-prevention/keeping-vehicles-safe/catalytic-converter-theft/>

We again have seen a number of thefts of purses from bags and phones from pockets while people are shopping along Green Lanes. Please make sure your purse is in your bag out of sight and your bag is zipped or clasped shut. A phone in an outside pocket is really easy for a thief to take.



Welcome to the latest Palmers Green Ward Safer Neighbourhoods Newsletter. This edition covers the crime figures on Palmers Green Ward for April 2022.

Crimes Recorded this month

There were 101 reported allegations of crime on Palmers Green Ward during this period.

Burglary

There were 1 residential burglary and 3 attempted residential burglaries during April.

GREENWOOD GARDENS, between 1.55pm and 2.10pm on 9th April. Unknown person has attempted to force open the rear door of the house and damaged the door.

LYNBRIDGE GARDENS, between 10.15pm and 11pm on 26th April. Suspects have forced open the side gate into the rear garden and then possibly opened the rear patio door as there were no signs of forced entry. They have then forced an internal door into the hallway alerting the owner who has shouted out and the suspects have left. Nothing appears to have been taken.

PALMERSTON CRESCENT, between 2.50am and 3am on 29th April. Several suspects were forcing entry to the front door of the victim's home saying they were police as they did so. When the victim arrived to stand on the other side of the door and was

Motor Vehicle Crime

There were 8 thefts from motor vehicles and 5 thefts of motor vehicles reported in April.

RIVER CRESCENT, between 12am, 27th March and 5.25pm, 3rd April. A 2019 Husqvarna 701 Enduro motorbike was taken from the location.

seen by the suspects they said something like they were sorry and wrong house before leaving. The door frame has been splintered and the glass smashed in the upper half of the front door.

ELMDALE ROAD, between 10am and 10.05am on 8th December 2021 (just now reported).

Victims found a bathroom window to be broken in the morning back in December and reported to their housing association not realising they should have called the police.

Please remember to double lock your front doors whether you have a UPVC door or have a Yale and mortice. If you also have a UPVC porch door then double lock that too. If you have the security installed, then please use it.

Please also consider the use of timer switches to light your houses up after dark if you are not yet home.

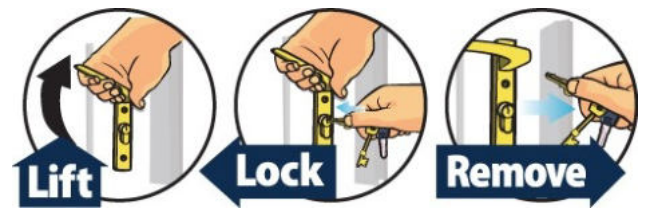

PLEASE TAKE NOTE OF THE INSTRUCTIONS FOR DOUBLE LOCKING A UPVC (THREE OR FIVE POINT LOCKING SYSTEM) DOOR.

If a UPVC door is not locked with a key the door handle goes down when tried and is left very weakly secure with a very small piece of triangular metal going into the frame. This point on the doorframe near the lock is where the suspects target with their screwdrivers or crowbars and can pop your door open sometimes with very little effort

HUXLEY PLACE, between 2.40am and 2.50am, 3rd April. A white 2017 Mercedes Sprinter Van was taken from the location.

LIGHTCLIFFE ROAD, between 2pm, 2nd April and 10am, 3rd April. Both number plates were taken from a vehicle.

NEW PARK AVENUE, at 1201am on 6th April. Neighbours disturbed some male suspects trying to steal a catalytic converter. They had cut it off but left it behind and drove off in a nearby car.

CONISCLIFFE ROAD, between 10am and 2pm on 7th April. A silver 2006 Toyota Hiace van was taken from the location possibly by a tow truck.

THE LARCHES, between 11.01am and 12pm on 8th April. A van was possibly left unlocked and two bags were taken containing address books, bank cards and £300.

LODGE DRIVE, between 9.30pm, 8th April and 2.30am, 9th April. A 2018 BMW X2 was taken after the victim left her key unattended on a table in KidzBiz. Has since been recovered after being involved in a road traffic collision.

HAZELWOOD LANE, between 5pm, 17th April and 8am, 18th April. Victim's car was entered and a blue badge taken.

DORCHESTER AVENUE, at 4.50am on 20th April. Police were called to a male trying door handles to vehicles along the road and was found by police to be taking items from a car parked on a drive. He was arrested for going equipped to steal and theft from a motor vehicle.

OAKTHORPE ROAD, between 7pm and 9.30pm on 22nd April. A number plate taken from a motorbike.

BROOMFIELD AVENUE, between 5.45pm, 23rd April and 10.46am, 24th April. A 2020 Mitsubishi outlander was taken overnight from a driveway via a relay attack. Found parked up on Firs Lane and returned to owner minus a phone and dash cam left inside.

DORCHESTER AVENUE, between 1.29am and 1.30am, 26th April. A wallet and contents were taken from a car.

NEW PARK AVENUE, between 12.55am and 2.30am, 29th April. A car was entered possibly using a device to open it and a bag of charity items, pot of loose change, bag of clothing to be returned and a red fleece were taken.

Robbery

There was 3 robberies reported during the past month.

ASH GROVE, between 10.20pm and 10.30pm, 4th April. The occupants of a car approached the victim and demanded his coat. The victim tried to walk away but the suspects wouldn't let him making threats. So the victim handed over his jacket and the suspects got back in the car and drove off.

NEW PARK AVENUE, 4pm on 11th April. A delivery driver received an order to deliver to an address and found it was three flats and called the telephone number for the order. A male answered and said he was on his way down and she was then confronted by a group of male suspects, one who put a gun to her helmet. They grabbed the motorbike key and she managed to retrieve her phone. One rode her bike off towards Firs Lane and the others left on foot and on bicycles. Bike has been found on Kendal Avenue by its tracker. Two suspects were detained and arrested nearby. Both have been charged.

BROOMFIELD AVENUE, between 2.20am and 2.38am, 15th April. The victim, a taxi driver picked up 6 males from Tottenham Road when the booking was for 4. He told them they had to pay beforehand because of this and they asked him to pull up on Broomfield Lane to get money out of a cashpoint. When he stopped the males got out and dragged him out of the car. He tried running off but they chased him and took his car keys and mobile phone before driving off in his car. Car was later found in N17.

! WATCH OUT

DON'T BE DISTRACTED!!

Distraction theft is a common tactic used by thieves. One talks to you while the other steals! Stay alert - Don't keep your bag unzipped! Don't use open pockets to store items!

 METROPOLITAN POLICE **BE SAFE**

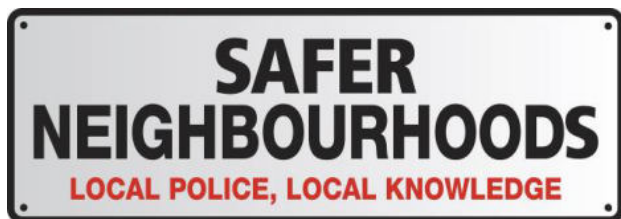

“Cuppa with a Copper.....”

Come and say Hello, for help and advice on local issues



Up coming events

Our next contact point will be on:

Saturday 14th May, 4pm-4.30pm, Hazelwood Rec (weather depending)

Friday 27th May, 2pm-2.30pm, Costa Coffee, Green Lanes N13

Saturday 11th June, 9am-10am, Groveland's Park for Parkrun

Team Members

Based at Edmonton Police Station your Dedicated Ward Officers (DWOs) on Palmers Green ward are:

PS Kathryn Pinkerton

PC Freddie Fitches

PC Shannon Shears

PCSO Jennifer Arkwright

We can be contacted via the telephone on:

0208 721 2835 (please leave a message if no answer – name, number, address and short message.)

Or via email:

Palmersgreen.snt@met.police.uk

Useful Contacts

24/7 Police Station

- Edmonton Police station
462 Fore Street, Edmonton N9 0PW

999 – URGENT attendance required – Response time of under 15mins.

101 - Police required but not as an emergency Response and also to report crime

0208 721 2835 – Palmers Green Ward - residents, wishing to contact their Local Policing Team for advice/arrange a visit/on going neighbourhood problems, etc. Slow time or appointment driven police attendance or communication required. Please do not use this number to report crime as this phone is not answered 24/7

You can now report crime online at www.met.police.uk by clicking the Report button.

Don't forget to follow us on Twitter for crime prevention advice, local events and meetings.

@MPSEnfield and **Palmers Green Twitter @MPSPalmersGreen**

Do not report crime on Enfield Twitter accounts. Please Report via @MettCC

In emergencies always call 999.

Twitter is not staffed 24/7

We are also on www.nextdoor.co.uk under Enfield Police



Get alerts from your local policing team and Neighbourhood watch. If you've not already sign up today at <https://www.owl.co.uk/met/>

If anyone would like a crime prevention survey please contact us via 0208 721 2835 or if you have access to a computer email us at palmersgreen.snt@met.police.uk

Palmers Green web page can be found on the Metropolitan Police website by visiting www.met.police.uk scrolling down the page and typing Palmers Green in the find your area box.



Many people we visit are asking for ID when we visit them. However, would you know what a real Met Police warrant card looks like?

The one BELOW is the real one. Check for the hologram on the warrant card (front and rear), and the signature of the Commissioner NOT the holder.

