

# Chase Farm Hospital redevelopment – planning application update

Andrew Panniker

Director of capital and estates

Maggie Robinson

Head of property

# Background

## Existing site

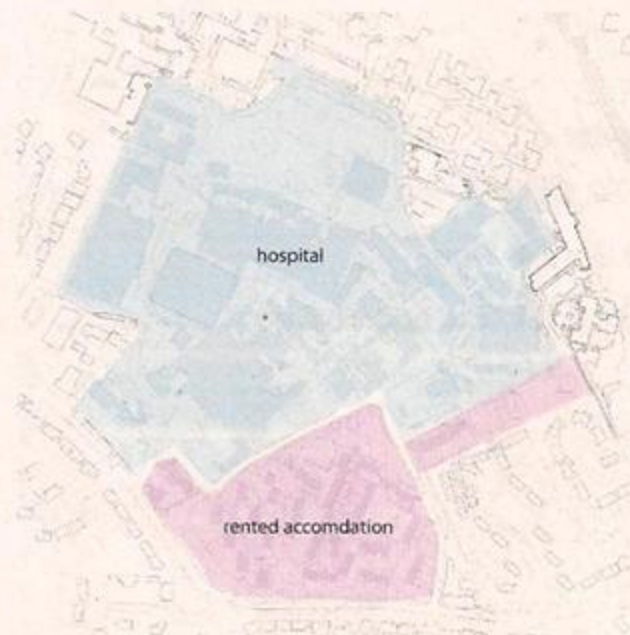

- Existing buildings are dispersed over the site
- Buildings in poor state of repair
- Design of the facilities not suitable for modern healthcare

The solution - deliver BEH services via a comprehensive redevelopment of the site

The trust has submitted an outline planning application

# Proposed timescales

November 2014:	outline planning submitted
January 2015:	outline business case to trust board and DH
March 2015:	enabling works/site assembly
Early 2015:	surplus land sold in phased parcels
May 2015:	reserved matters planning
Summer 2015:	full business case to trust board and DH
January 2016:	main works start
Spring 2018:	new hospital opens
Autumn 2018:	potential for school to open



# Engagement with stakeholders

- **Widespread support**
- **Much engagement with local community**
  - Stakeholders' events - 21 July, 22 Sept, 3 Nov
  - Residents' events - 28 July, 29 Sept, 6 Nov
  - Tenants' events - 28 July, 29 Sept, 11 Nov and 16 Dec
- **Addressing concerns raised**

# Proposed masterplan

new hospital campus - 17 acres

new residential units - 18 acres

new school - 4 acres



indicative masterplan

world class expertise  local care

Royal Free London   
NHS Foundation Trust

# Planning application

An outline parameter planning application was submitted on 21 November and consists of the following elements:

## Healthcare

Up to 32,000 sq m of replacement hospital facilities - allows for expansion and future proofing

## New housing

Up to 500 residential units - surplus land to healthcare requirements will be sold to part fund the new hospital

## New primary school

New three-form entry primary school including temporary facilities

# Utilization of healthcare buildings

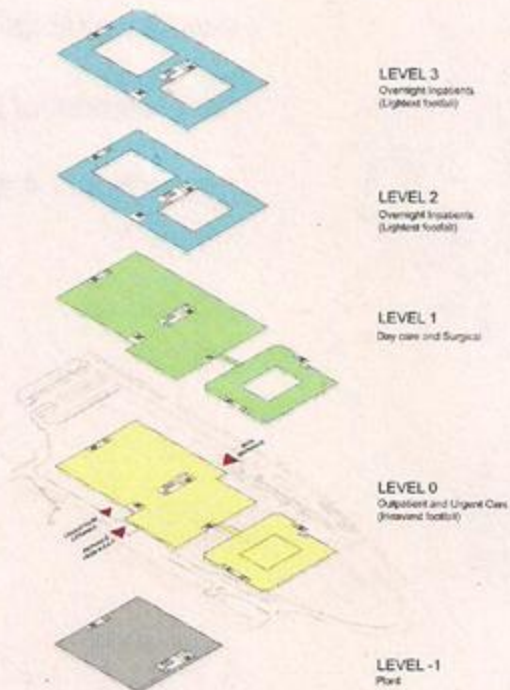

world class expertise  local care

Royal Free London   
NHS Foundation Trust



# Clinical functional content

- 48 in-patient elective surgical beds
- 8 theatres
- 16 theatre recovery spaces
- 4 high dependency unit (HDU) beds
- 15 day case beds
- 44 in-patient rehabilitation beds
- 10 space planned investigative treatment unit (PITU)
- 10 space haematology/oncology day unit
- Urgent care centre (UCC) - 7 consulting rooms, 1 minor ops room and 1 plaster room



# Clinical functional content cont.

- GP out of hours service - 1 consulting room
- older people's assessment unit (OPAU) - 9 consulting rooms, 1 treatment room
- paediatric assessment unit (PAU) - 3 PAU consulting rooms
- paediatric out-patients - 7 consulting rooms, 1 treatment room
- adult out-patients - 18 generic consulting rooms, plus breast clinic, physiological measurement, oral, orthodontic, ENT, audio and maxillo-facial surgery, ophthalmology and gynaecology suite

# Clinical functional content

- 6 virtual consult booths for telemedicine
- 6 phlebotomy bays
- anti-coagulation service space
- physiotherapy and musculo-skeletal (MSK) space on the wards and in OPAU
- 4 endoscopy rooms (plus an additional 2 shell spaces for future growth)
- diagnostics: 4 x-ray rooms, 6 ultrasound, 1 MRI plus 1 mobile MRI, 1 CT scanner plus fluoroscopy function within x ray
- pharmacy
- non clinical space: café, restaurant, retail unit, administration hot desking, teaching space, FM allowance and stores

# Further information

The planning application is available to view and comment on at <http://planningandbuildingcontrol.enfield.gov.uk/online-applications>

The planning application documents are available in the restaurants at Chase Farm Hospital, Barnet Hospital, the Royal Free Hospital and Enfield Town Library.

The consultation closes on 2 January 2015.

Further information is available on our website at [www.royalfree.nhs.uk/chasefarm](http://www.royalfree.nhs.uk/chasefarm)